

PPR Poly-Flo

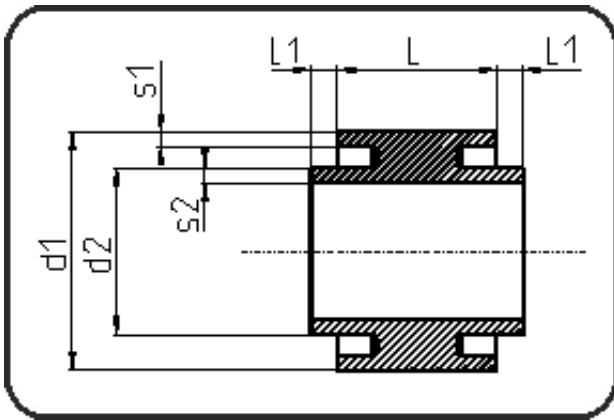

Code: 195

- Poly-Flo Festpunkt
- ohne Cut Out
- mechanisch gefertigt
- **Simultan + Kaskadenschweissung**
- PPR grau

Dimension	Code	Detail	Gewicht
90/63	11.195.9063.71	90/63 SDR17/11	0.20

	Einheit	Nominale	Tol+	Tol-
L	mm	60	3.00	3.00
L1	mm	10	1.50	1.50
d1	mm	90	1.35	0.00
s2	mm	5,8	0.70	0.00
d2	mm	63	0.90	0.00
s1	mm	5,4	0.70	0.00