

PE/PE Simultanschweissung

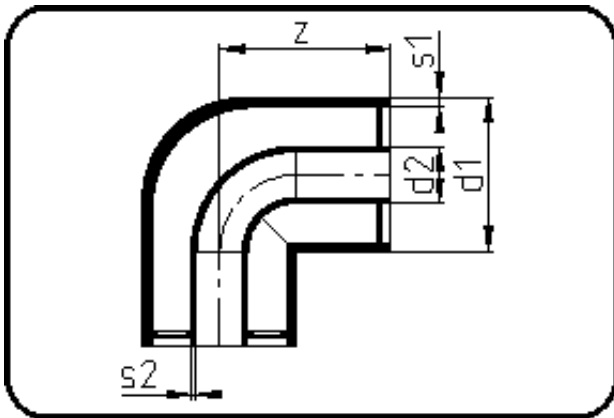

Code: 101

- Bogen 90°
- formgespritzt+vormontiert
- **Simultanschweissung**
- PE 100-RC/PE 100-RC

Dimension	Code	Detail	Gewicht
355/250	82.101.3525.31	355/250 SDR33/11	15.38

	Einheit	Nominale	Tol+	Tol-
d1	mm	355	0.00	0.00
SDR2		11	0.00	0.00
SDR1		33	0.00	0.00
s2	mm	22,8	0.00	0.00
d2	mm	250	0.00	0.00
s1	mm	10,9	0.00	0.00
z	mm	340	0.00	0.00