

## Rohrbögen

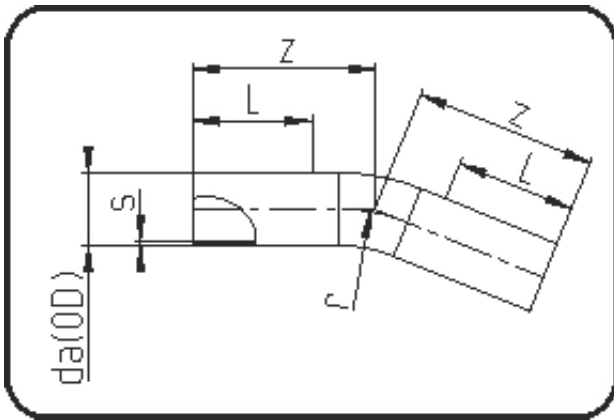

Code: 395

- Rohrbogen 22°
- Radius 1,5 x da
- aus Rohr geformt
- **Stumpf+Heizwendelschweissung**
- **PE 100-RC schwarz**

Dimension	Code	Detail	Gewicht
140	70.395.0140.11	140 SDR11 ISO S-5 16 bar	3.96

	Einheit	Nominale	Tol+	Tol-
da(OD)	mm	140	0.00	0.00
L	mm	150	0.00	0.00
r	mm	210	0.00	0.00
s	mm	12,7	0.00	0.00
z	mm	395	75.00	75.00