

Rohrbögen

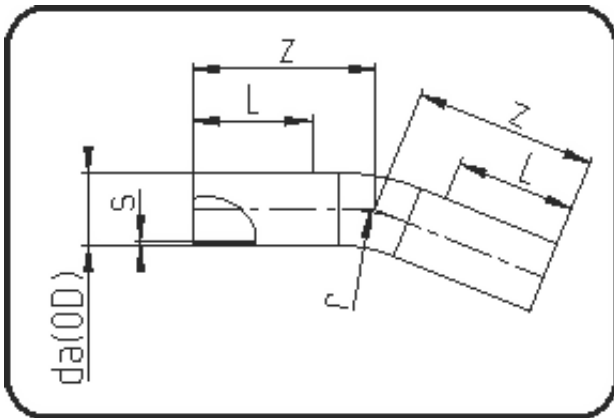

Code: 395

- Rohrbogen 22°
- Radius 1,5 x da
- aus Rohr geformt
- **Stumpf+Heizwendelschweissung**
- **PE 100-RC schwarz**

Dimension	Code	Detail	Gewicht
180	70.395.0180.17	180 SDR17 ISO S-8 10 bar	5.08

	Einheit	Nominale	Tol+	Tol-
da(OD)	mm	180	0.00	0.00
L	mm	150	0.00	0.00
r	mm	270	0.00	0.00
s	mm	10,7	0.00	0.00
z	mm	450	50.00	50.00