

## Rohrbögen

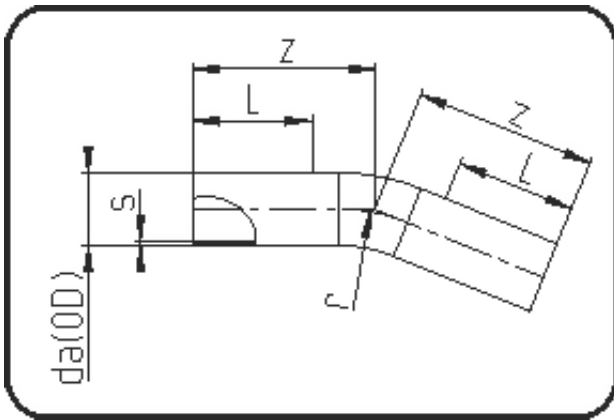

Code: 395

- Rohrbogen 22°
- Radius 1,5 x da
- aus Rohr geformt
- **Stumpf+Heizwendelschweissung**
- **PE 100-RC schwarz**

Dimension	Code	Detail	Gewicht
225	70.395.0225.11	225 SDR11 ISO S-5 16 bar	13.36

	Einheit	Nominale	Tol+	Tol-
da(OD)	mm	225	0.00	0.00
L	mm	150	0.00	0.00
r	mm	338	0.00	0.00
s	mm	20,5	0.00	0.00
z	mm	510	75.00	75.00