

## Rohrbögen

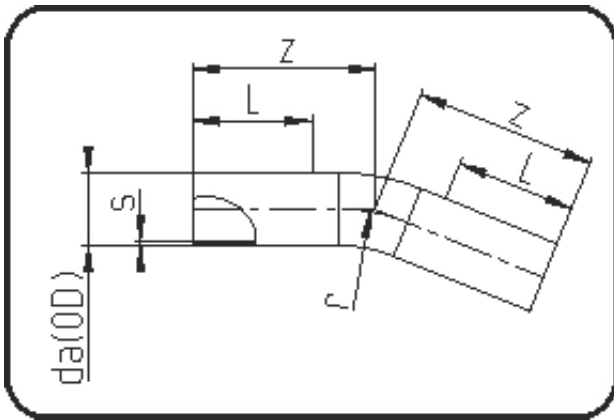

Code: 395

- Rohrbogen 22°
- Radius 1,5 x da
- aus Rohr geformt
- **Stumpf+Heizwendelschweissung**
- **PE 100-RC schwarz**

Dimension	Code	Detail	Gewicht
250	70.395.0250.11	250 SDR11 ISO S-5 16 bar	17.66

	Einheit	Nominale	Tol+	Tol-
da(OD)	mm	250	0.00	0.00
L	mm	250	0.00	0.00
r	mm	375	0.00	0.00
s	mm	22,7	0.00	0.00
z	mm	550	75.00	75.00