

## Rohrbögen

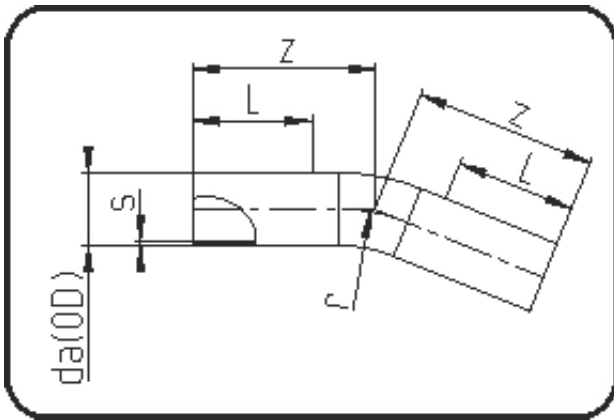

Code: 395

- Rohrbogen 22°
- Radius 1,5 x da
- aus Rohr geformt
- **Stumpf+Heizwendelschweissung**
- **PE 100-RC schwarz**

Dimension	Code	Detail	Gewicht
280	70.395.0280.17	280 SDR17 ISO S-8 10 bar	15.20

	Einheit	Nominale	Tol+	Tol-
da(OD)	mm	280	0.00	0.00
L	mm	300	0.00	0.00
r	mm	420	0.00	0.00
s	mm	16,6	0.00	0.00
z	mm	550	75.00	75.00