

Rohrbögen

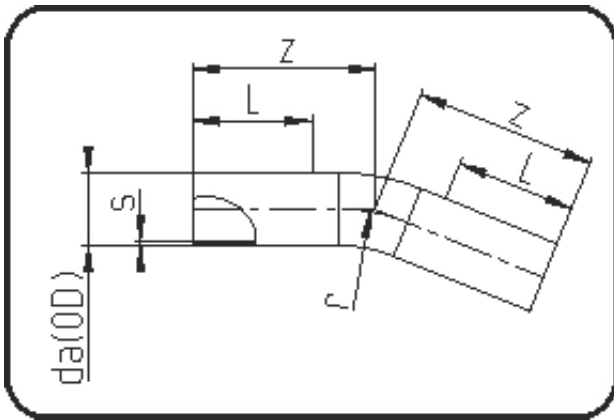

Code: 395

- Rohrbogen 22°
- Radius 1,5 x da
- aus Rohr geformt
- **Stumpf+Heizwendelschweissung**
- **PE 100-RC schwarz**

Dimension	Code	Detail	Gewicht
450	70.395.0450.17	450 SDR17 ISO S-8 10 bar	64.40

	Einheit	Nominale	Tol+	Tol-
da(OD)	mm	450	0.00	0.00
L	mm	550	0.00	0.00
r	mm	675	0.00	0.00
s	mm	26,7	0.00	0.00
z	mm	900	75.00	75.00