

## Rohrbögen

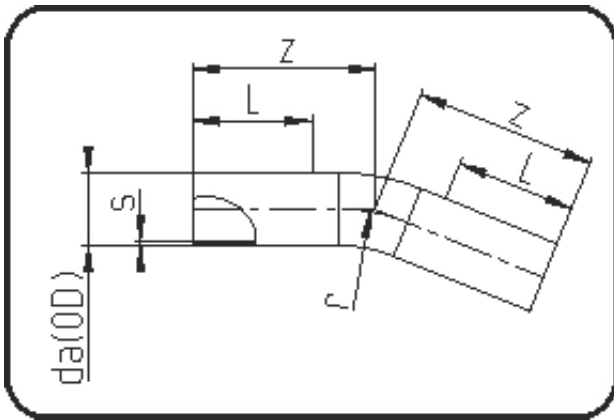

Code: 395

- Rohrbogen 22°
- Radius 1,5 x da
- aus Rohr geformt
- **Stumpf+Heizwendelschweissung**
- **PE 100-RC schwarz**

Dimension	Code	Detail	Gewicht
500	70.395.0500.17	500 SDR17 ISO S-8 10 bar	88.40

	Einheit	Nominale	Tol+	Tol-
da(OD)	mm	500	0.00	0.00
L	mm	600	0.00	0.00
r	mm	750	0.00	0.00
s	mm	29,7	0.00	0.00
z	mm	1.000	75.00	75.00