

Fittings for Socket Welding

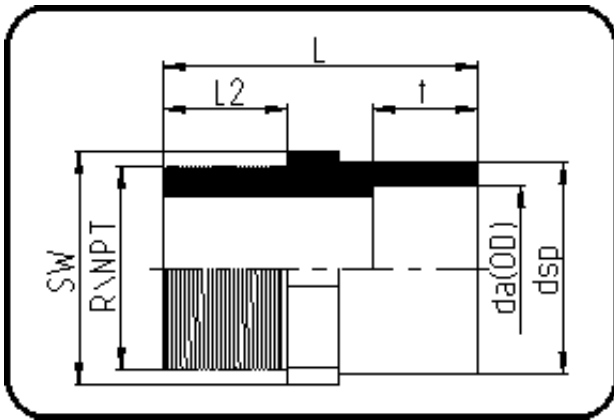

Code: 035.1

- Adaptor Male Thread
- NPT-thread
- injection moulded
- **Socket-welding**
- PPR grey

Dimension	Code	Detail	Weight
50	11.035.5064.07	50X2" - MOP 10 bar	0.09

	Unit	Nominale	Tol+	Tol-
da(OD)	mm	50	0.00	0.00
L	mm	78	3.00	3.00
NPT	inch	2	0.00	0.00
nr	ril	1,77	0.00	0.00
SW	mm	65	2.25	2.25
L2	mm	31	3.00	3.00
dsp	mm	63	0.90	0.00
t	mm	24	0.75	0.75
E	mm	11,07	0.00	0.00
K	mm	57,63	0.00	0.00