

## PP/PP Simultaneous Welding

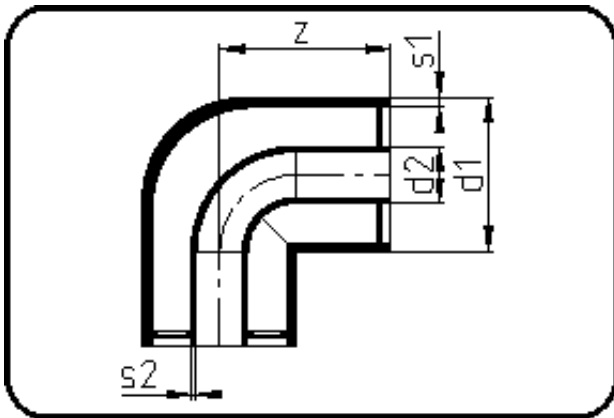

Code: 101

- Bend 90°
- injection moulded+assembled
- **Simultaneous-welding**
- **PP/PP**

Dimension	Code	Detail	Weight
160/90	80.101.1690.31	160/90 SDR33/11	1.50

	Unit	Nominale	Tol+	Tol-
d1	mm	160	0.00	0.00
SDR2		11	0.00	0.00
SDR1		33	0.00	0.00
s2	mm	8,2	0.00	0.00
d2	mm	90	0.00	0.00
s1	mm	4,9	0.00	0.00
z	mm	180	0.00	0.00