

Fittings with short Spigot

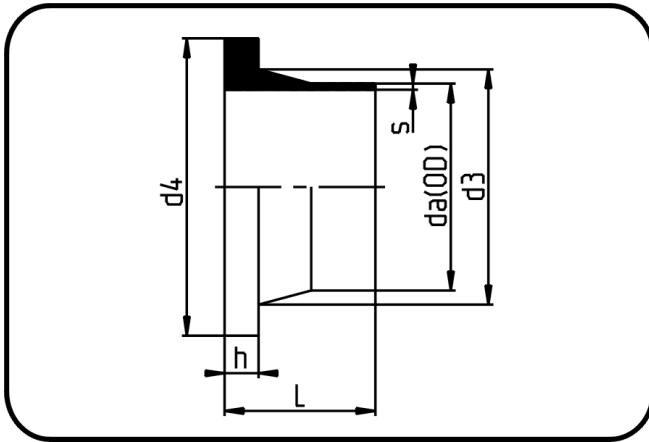

Code: 012

- **Stub Flange DIN**
- short spigot
- injection moulded
- **Butt-welding**
- **PE 100-RC black**

Backing Rings please see Accessories.

Dimension	Code	Detail	da(OD) mm	s mm	L mm	d3 mm	d4 mm	h mm	Weight
63	70.012.0063.11	63X5,8 SDR11 ISO S-5	63	5,8	50	75	102	14	0.13
75	70.012.0075.11	75X6,8 SDR11 ISO S-5	75	6,8	50,5	89	122	16	0.20
90	70.012.0090.11	90X8,2 SDR11 ISO S-5	90	8,2	80	105	138	17	0.34
110	70.012.0110.11	110X10,0 SDR11 ISO S-5	110	10	80	125	158	18	0.46
125	70.012.0125.11	125X11,4 SDR11 ISO S-5	125	11,4	80	132	158	25	0.51
140	70.012.0140.11	140X12,7 SDR11 ISO S-5	140	12,7	92	155	188	25	0.82
160	70.012.0160.11	160X14,6 SDR11 ISO S-5	160	14,6	92	175	212	25	1.03
180	70.012.0180.11	180X16,4 SDR11 ISO S-5	180	16,4	93	183	212	30	1.06
200	70.012.0200.11	200X18,2 SDR11 ISO S-5	200	18,2	114	232	268	32	2.18
225	70.012.0225.11	225X20,5 SDR11 ISO S-5	225	20,5	113	235	268	32	2.10
250	70.012.0250.11	250X22,7 SDR11 ISO S-5	250	22,7	130	285	320	35	3.56
280	70.012.0280.11	280X25,4 SDR11 ISO S-5	280	25,4	128	288	320	35	3.32
315	70.012.0315.11	315X28,6 SDR11 ISO S-5	315	28,6	136	335	370	35	5.00
355	70.012.0355.11	355X32,2 SDR11 ISO S-5	355	32,2	150	373	430	40	6.88
400	70.012.0400.11	400X36,3 SDR11 ISO S-5	400	36,3	155	427	482	46	9.04
450	70.012.0450.11	450X40,9 SDR11 ISO S-5	450	40,9	166	514	585	60	16.00
500	70.012.0500.11	500X45,4 SDR11 ISO S-5	500	45,4	175	530	585	60	15.76
560	70.012.0560.11	560X50,8 SDR11 ISO S-5	560	50,8	180	615	685	60	22.78
630	70.012.0630.11	630X57,2 SDR11 ISO S-5	630	57,2	175	642	685	60	22.01